

Vertical balers

X-series



Baler X10 HD

Powerful press force

The X10 HD is a small and compact machine with a powerful press force that's unique for its size.

Safe ejection process

The ergonomic two-hand ejection sequence safely ejects the finished bale and eliminates risk for injury.

Highlights

- Efficient and compact
- Low overall height (75 in.) with internal cross cylinders
- Fast cycle time
- Press force of 22,000 lbs.
- Small footprint (52 x 41 x 75 in.)
- Durable compaction
- Available in both single-phase and three-phase power packs

Optional Extras



Balers are available in other RAL colours which you may choose.



Top-mounted strap holder lets you install your baler close to the wall.

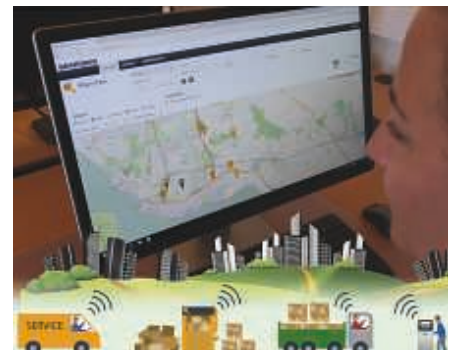

Get online access to your balers with our monitoring system called BRA-IN.

Product details

Baler X10 HD



Whisper

30 dB



Refrigerator

50 dB



X10 HD baler

59-60 dB



Other balers

75 dB

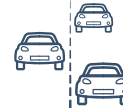

Cars on highway

100 dB



Turbojet engine

160 dB

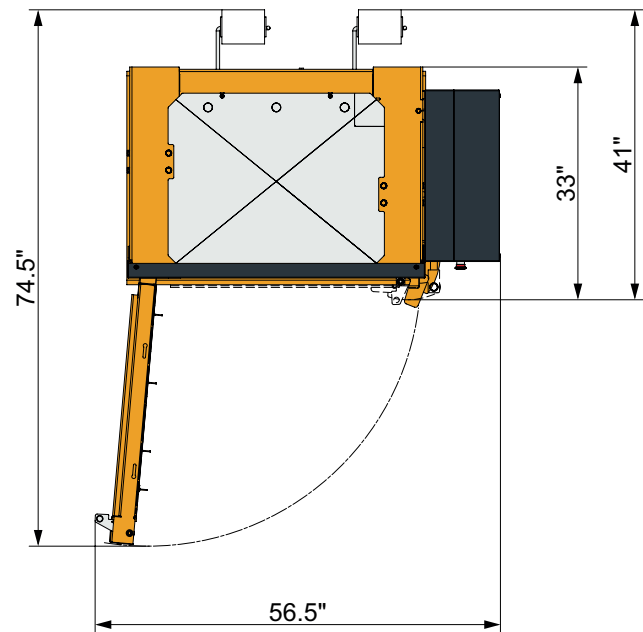
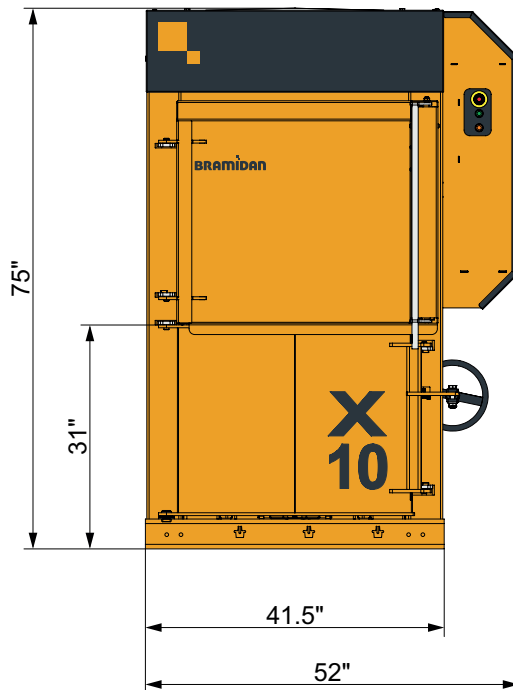

Technical specifications

Bale size WxDxH (inch)	30 x 24 x 24
Feed opening WxH (inch)	31 x 24
Power supply	110V 1-Phase 60Hz 20A
Motor (HP)	5.5
Cycle time avg. (sec)	40
Dimensions WxDxH (inch)	52 x 41 x 75
Machine weight (lbs)	1,470
Stroke (inch)	33
Number of ties	3
Type of tying	Twine
Full bale light	Yes
Bale eject	Automatic



Bale weight

Cardboard (lbs)	150-200
Plastic foil (lbs)	175-245



Press force

22,000 lbs



Noise level

62-64 dB



Waste types

Cardboard, plastic foil, paper, PET bottles, alu- and tin cans, plastic hard, textile, EPS.